

# Automotive 6504 SERIES



## 3.5 Pitch Power Connector



### 6504P HID Connector

#### ■ Specifications

- ◇ Current rating : 4A AC/DC
- ◇ Voltage Range : 200V AC,DC
- ◇ Withstand Voltage : 2000V AC
- ◇ Insulation Resistance : 500 MΩ Min.
- ◇ Temperature Range: -40°C to 105°C

#### ■ Reference

- ◇ Use in HID ballast's connector

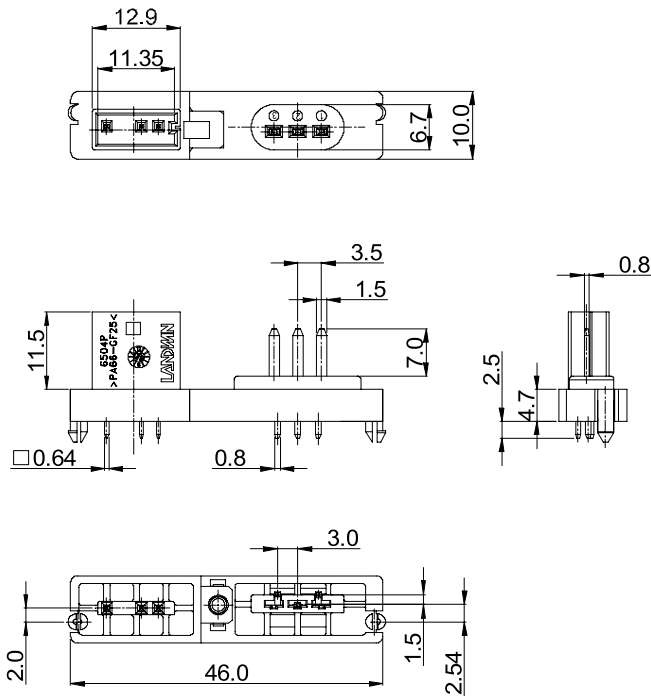
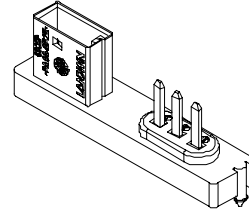

#### Material

Part	Material/Plated
Housing	PA66+25%GF UL94V-0,Black
Terminal	BRASS, Matte Tin-Plated

※ Available P/N of Halogen-Free replacement:  
6504P06A7V-BNH

#### P.C. Board Layout / Assembly Layout

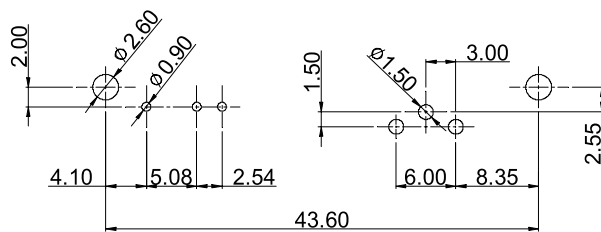

# Automotive 6506 SERIES



## 3.5 Pitch Power Connector



### 6506F Plug Housing

#### ■ Specifications

- ◇ Current rating : 19A AC/DC (AWG 16)
- ◇ Voltage Range : 12V AC,DC
- ◇ Withstand Voltage : 1800V AC/Minute
- ◇ Insulation Resistance : 1000 M $\Omega$  Min.
- ◇ Contact Resistance : 10 m $\Omega$  Max.
- ◇ Temperature Range: -30°C to 105°C
- ◇ Wire Range: AWG 16 to AWG 22

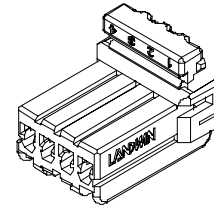

#### ■ Reference

- ◇ Use with 66502T021R Terminal
- ◇ Mates with 6506M Receptacle Housing

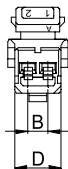

2 PIN

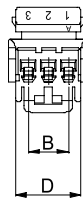

3 PIN

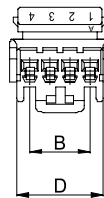

4 PIN

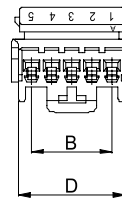

5 PIN

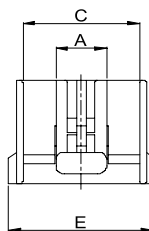
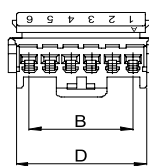
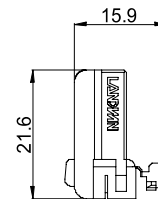
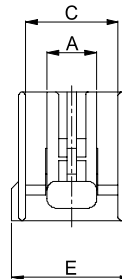
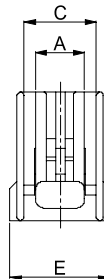
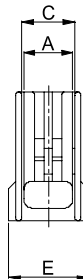
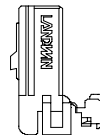
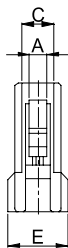

6 PIN

#### Ordering Information

Circuits	Part No.	Dimension				
		A	B	C	D	E
2	6505F0201	3.0	3.5	5.5	8.0	10.4
3	6506F0301	8.6	7.0	9.2	11.5	13.9
4	6506F0401	8.6	10.5	12.7	15.0	17.4
5	6506F0501	8.6	14.0	16.2	18.5	20.9
6	6506F0601	8.6	17.5	19.7	22.0	24.4

#### Material

Part	Material
Housing	Nylon 66 94V-0, Natural (White)

※ Available P/N of Halogen-Free replacement:  
6506F xx 01-SNH

# Automotive 6506 SERIES



## 3.5 Pitch Power Connector



### 6506M Receptacle Housing

- ◆ Current rating : 19A AC/DC (AWG 16)
- ◆ Voltage Range : 12V AC,DC
- ◆ Withstand Voltage : 1800V AC/Minute
- ◆ Insulation Resistance : 1000 MΩ Min.
- ◆ Contact Resistance : 10 mΩ Max.
- ◆ Temperature Range: -30°C to 105°C
- ◆ Wire Range: AWG 16 to AWG 22

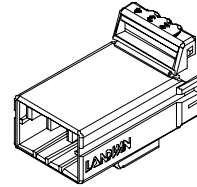

#### Reference

- ◆ Use with 66501T022R Terminal
- ◆ Mates with 6506F Plug Housing

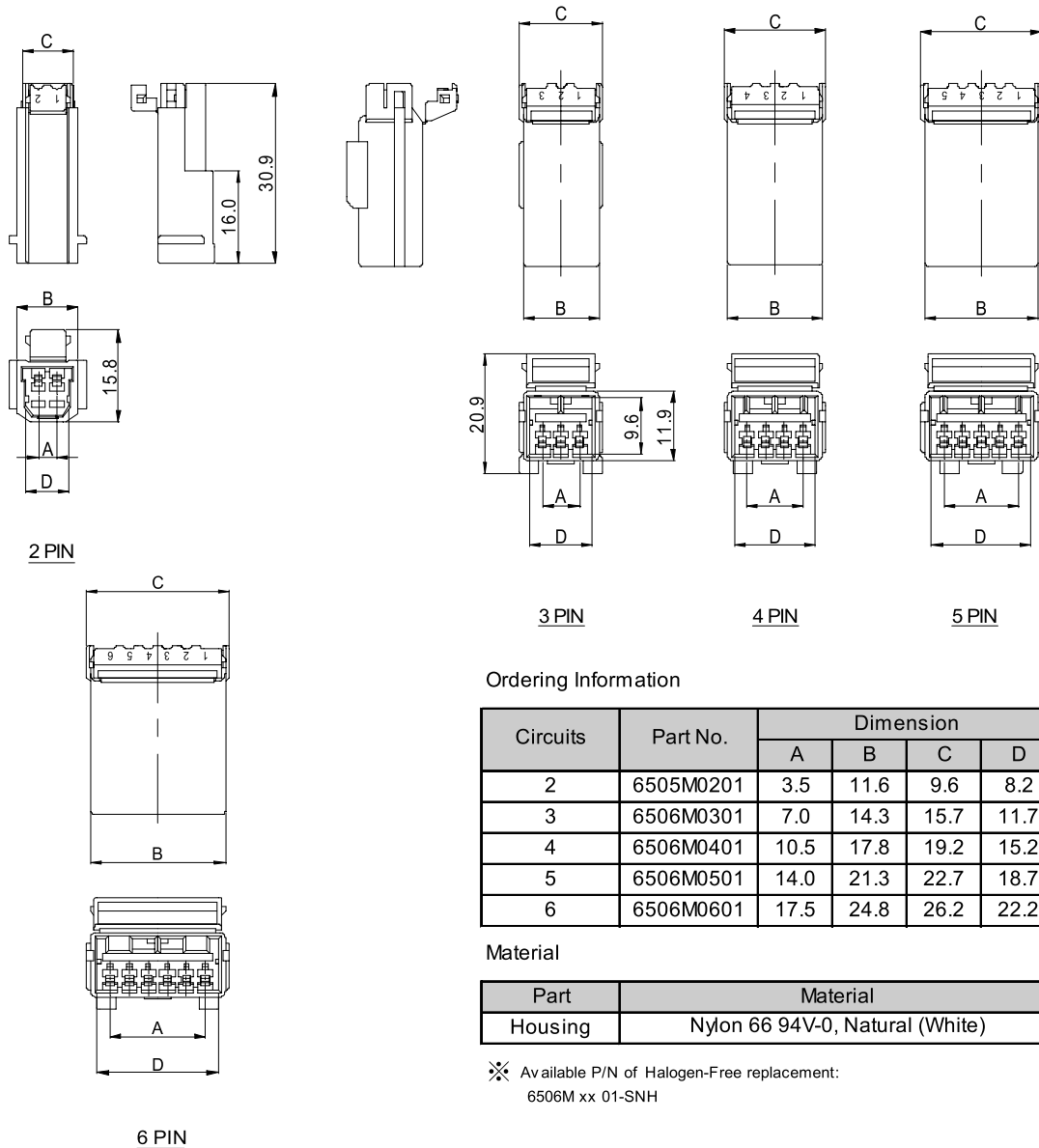

#### Ordering Information

Circuits	Part No.	Dimension			
		A	B	C	D
2	6505M0201	3.5	11.6	9.6	8.2
3	6506M0301	7.0	14.3	15.7	11.7
4	6506M0401	10.5	17.8	19.2	15.2
5	6506M0501	14.0	21.3	22.7	18.7
6	6506M0601	17.5	24.8	26.2	22.2

#### Material

Part	Material
Housing	Nylon 66 94V-0, Natural (White)

※ Available P/N of Halogen-Free replacement:  
6506M xx 01-SNH

# Automotive 6506 SERIES



## 3.5 Pitch Power Connector



### 6506P HID Connector

#### ■ Specifications

- ◇ Current rating : 19A AC/DC (AWG 16)
- ◇ Voltage Range : 12V AC,DC
- ◇ Withstand Voltage : 2000V AC/Minute
- ◇ Insulation Resistance : 500 MΩ Min.
- ◇ Contact Resistance : 6 mΩ Max.
- ◇ Temperature Range: -30°C to 105°C

#### ■ Reference

- ◇ Mates with 6506F Plug Housing

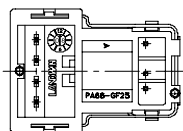
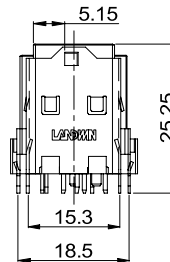
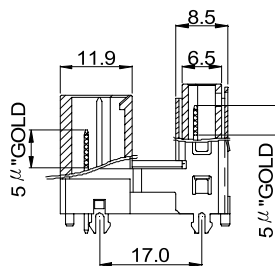
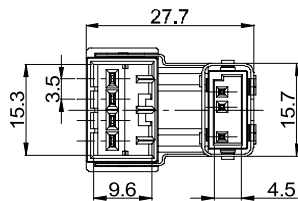
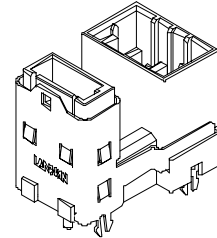

PART NO.: 6506P0707C

#### Material

Part	Material/Plated
Housing	Nylon 66+25%GF UL94V-0, Black
Shell	Brass, Tin-Plated
Pin	Brass, Select-Gold Plated

✧ Available P/N of Halogen-Free replacement:  
6506P0707C-BNH

#### P.C. Board Layout / Assembly Layout

